

## Keeping Up With the Pace of Implantology



Only 20 years ago, osseointegrated dental implants were considered a high-risk dental solution. Today, they are accepted as a standard procedure in dentistry. Alloys used for prosthetic restorations have not been able to keep up with this rate of improvement. Utilizing its long history of scientific-based metallurgical knowledge and extensive biological and metallurgical testing experience, Metalordental has sped up and now offers **Implantalloy 1, 2, and 3** – meeting even higher levels of thermal stability, hardness, colour and biological acceptance.

To a certain extent, all materials in the oral environment react with saliva and release different ions that have been shown to have a biological impact on the oral tissues. Metalordental has taken biocompatibility testing to the next level by evaluating its alloys for galvanic corrosion when in

direct contact with titanium implants. Making use of these test results, **Implantalloy 1, 2, and 3** are characterized by exhibiting extremely low galvanic corrosion – resulting in minimal ion release in the oral environment.



1 for aesthetics

Implant aesthetics normally allows zero tolerance in the eyes of the patient. The colour of the alloy can be the deciding aesthetic effect on the resulting hue of the ceramic. With its rich golden colour, **Implantalloy 1** assists in underlying all ceramic restorations with a correct tinge. The light oxide layer enables excellent aesthetics even in situations with reduced space. **Implantalloy 1** has been tested for all single crowns and three unit bridges in the anterior region and is recommended in all cases where aesthetics is paramount.

Au 82%, Pt 12.4%, Pd 1.0%, Ag 2.1%, In 1.3%, Ir, Cu, Zn <1%  
CTE: 13.9 (25-500°C 10-6K-1) / 14.2 (20-600°C 10-6K-1)



2 for precision fit

The most common cause of implant failure can be poorly fitting prosthetic restorations. Therefore, it is of the utmost importance for all implant-supported bridges to have a 100% passive fit in order to avoid micro movements. The greatest risks of restoration deformation occur during the ceramic firing process when the alloys are taken to the limits of their thermal stability. Consequently, with **Implantalloy 2**, greatest emphasis was placed on thermal stability plus excellent galvanic corrosion resistance when in contact with titanium.

Au 52%, Pd 38%, In 8.5%, Ga 1.5%, Ru <1%  
CTE: 13.8 (25-500°C 10-6K-1) / 14.1 (20-600°C 10-6K-1)



3 for hardness

In addition to their biocompatibility, milled surfaces on implant-supported prosthetics should be judged on hardness and their polishing ability. Precision in milling depends on the hardness of the alloy – if the alloy is not hard enough, the milled surfaces lose precision during polishing and finishing. For a stable seating of removable prosthetics on implants, precision of the milled surfaces is imperative. With a Vicker's Hardness of 280, **Implantalloy 3** is specially designed to offer ideal milling qualities.

Au 61%, Pd 3.3%, Ag 23%, Cu 11%, Zn 1%, Ir <1%  
Vicker's Hardness: 280 (HV 5/30)  
E-Module: 110,000

Implantalloy 1 & 2 alloys can also be used when Pressing-To-Metal with SNF PressCeram™.

## A New Cobalt - Chrome Alloy

**Metalloy® CC** contains 61.5% cobalt, 27.5% chrome, 8.6% tungsten, 1.3% silicon and less than 1% of other elements, and is free of nickel, beryllium, gallium, indium and iron. It is a highly compatible alloy for crowns, bridges and model casting. **Metalloy® CC** is suitable for all melting methods. It demonstrates outstanding, reliable melting and casting behaviour with no splitting during melting. This new generation alloy from Metalordental gives dentists and dental technicians an extremely wide scope in the design of fixed and model cast prostheses and combined dentures within a non-precious metal system.



## Introducing a New Distal Extension Hinge Attachment

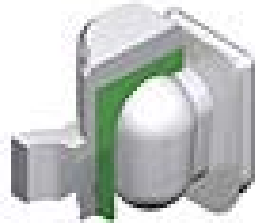

The **Ancro R** is a mobile, friction-grip extra-coronal slide attachment. It consists of a pear-shaped male part suitable for casting-on or a combustible male part suitable for casting in. The male part is used in combination with the female part, which has interchangeable friction-grip sleeves. The ingenious shape of the male part allows the female part to make slight rotational and micro-controlled movements.

Order #	Description	Pcs.	Material	Price
200014788	Ancro R Set (male+female+sleeve)	1	Burn-out Plastic	\$ 38.00
200014789	Female Part (female+sleeve)	1	Burn-out Plastic	\$ 20.00
200014790	Male Part	1	Burn-out Plastic	\$ 20.00
200014783	Ancro R Set (male+female+sleeve)	1	Cast-to, White, Precious Alloy	\$ 165.00
200014785	Female Part (female+sleeve)	1	Cast-to, White, Precious Alloy	\$ 85.00
200014787	Male Part	1	Cast-to, White, Precious Alloy	\$ 85.00

### Spare parts & Accessories:

200014786	Sleeve - standard/green (1)	1	Plastic	\$ 6.50
200014791	Sleeve - soft/yellow (1)	1	Plastic	\$ 6.50
200014792	Sleeve strong/red (1)	1	Plastic	\$ 6.50
200014793	Mandrel f.male part in plastic (1)	1	Stainless Steel	\$ 40.00
200014794	Mandrel f.male part in metal (1)	1	Stainless Steel	\$ 40.00
200014795	Guide pin (1)	1	Stainless Steel	\$ 6.50
200014797	Sleeve mounting aid (1)	1	Stainless Steel	\$ 28.00
200014798	Duplicating aid (1)	1	Stainless Steel	\$ 9.50
200014799	Transfer Jig (1)	1	Stainless Steel	\$ 16.75

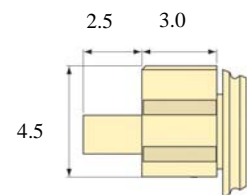
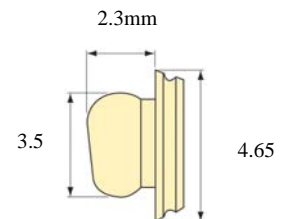

## What's New With SNF PressCeram™ ?



SNF PressCeram™ has two new ingot shades that are perfect for veneering! A pearl has natural opalescence that is truly beautiful. We wanted to transfer this beauty to a new shaded veneering ingot. SNF PressCeram™ is excited to introduce the **PRL 1** ingot. The ingot has a perfect combination of opalescence and translucency that gives dentists and technicians the opportunity to create natural-looking restorations. The brilliance of the **PRL 1** ingot is ideal for veneering or full crown restorations. SNF PressCeram™ is also proud to introduce the **CT** shaded ingot. This popular shade is a great alternative for technicians. The **CT** ingot mimics nature and is perfect for veneering and full-crown restorations. Also, both of the new ingots can be pressed to metal.

The **SNF PressCeram™ Labels** have a new look. The labels for the porcelain bottles have been given a fresh design. Along with making the information on the bottles easier to read, the label colour coding system makes the porcelain types easier to distinguish from each other. The new labels will gradually be distributed as the supplies of the classic labels are depleted. The **SNF PressCeram™ Instruction Manual** has also been updated to include additional, clearer information to assist technicians in creating beautiful restorations with ease.



SWISS NF METALS, INC.

# THE SWISS NF METALS NEWSLETTER

"A COMPANY FOR DENTAL SOLUTIONS"

VOLUME 1, ISSUE 1

FALL 2005

## The SNF PressCeram™ - Alumina Has Arrived!



With the growing popularity of Alumina ( $Al_2O_3$ ) based substructures in esthetic restorative dentistry, it is only fitting that SNF PressCeram™ has grown to include a system that is compatible with Alumina substructures. **SNF PressCeram™ - AL** is indicated for Alumina frameworks for such systems as Wol-Ceram®, In-ceram®, Procera®, or any other 'Alumina-type' milling blocks. **The SNF PressCeram™ - AL** porcelain pressing ingots enable the reconstruction of natural teeth when pressed to Alumina crowns and frameworks. **The SNF PressCeram™ - AL** layering ceramic is a low fusing (780°C) dental material, used for the production of crowns and bridges containing Alumina based frameworks. The layering ceramic can be used either with the pressing technique or independently and directly on the Alumina substructure. Being able to press to Alumina allows the technician to create excellent marginal fit, accurate pressed design, and beautiful metal-free esthetics.

### Coming Soon... SNF PressCeram – Z / Ti

The SNF PressCeram™ family will soon have its third addition. **PressCeram™ - Z/Ti** will have an ingot that will enable you to press to Zirconia frameworks. There will also be a beautiful layering ceramic in the system that will be compatible with Zirconia and Titanium. Introduction is expected near the end of 2005.

## SNF Forestadent Dura-Fit® Molar Bands



The benefits of using **Dura-Fit® Molar Bands** are as follows:

- Perfect anatomical fit through lingual and buccal adaptation and cusp indents.
- Easy placing through reduced inter-proximal band thickness
- Unique snap-on effect
- Laser Marking for easy identification
- Statistically calculated assortments in up to 32 sizes

## A Great Burn Out Post For a Great Value

The **SDI Burn Out Post** offers you a quick and economical method of perfecting cast post and cores. The serrated post design allows for an even distribution of the wax. The posts are made of special plastic that burns out cleanly, leaving no residue and thus avoiding porosity in the casting.



<u>Order #</u>	<u>Description</u>	<u>Price</u>
14-01	SDI Burn Out Posts (60)	\$14.00

## A Diamond Polishing Paste That 'Shines'



**Legabril Diamond** is a fine polishing compound containing diamond particles. It is indicated for all precious and non-precious dental alloys. **Legabril Diamond** is particularly suitable for high gold dental alloys (use a handpiece speed of less than 10,000 rpm). **Legabril Diamond** is also an excellent compound to polish ceramics and composites. When polishing any material, the diamond particles allow for a quick shine, which provides substantial time saving in the lab.

<u>Order #</u>	<u>Description</u>	<u>Price</u>
300000087	Legabril Diamond (50g)	\$45.00



# THE SWISS NF METALS NEWSLETTER

"A COMPANY FOR DENTAL SOLUTIONS"

VOLUME 1, ISSUE 1

FALL 2005

## **50% OFF Clearance Sale\*!**

**Kenda Titanium and Precious Alloy Polishers** are on sale\*! The **Kenda Titanium & Precious Alloy Polishers** reduce the risk of plaque formation on titanium and give brilliant results in just two easy steps. Use the black instruments (7,500-10,000 rpm) for finishing and pre-polishing. Then use the green polisher for a high shine in a matter of seconds. The green polishers (5,000-7,500 rpm) have micro-fine diamond particles with self-sharpening cutting edges giving an efficient, beautiful result with precious metals and titanium alloys. Don't miss this opportunity for great savings\*!

Order #	Description	Regular	SALE*
19-741	Kenda Titanium Starter Kit (as shown in the picture)	\$ 55.60	<b>\$ 27.80</b>
19-1000HP-6	Kenda Titanium/Precious Black Pre-polisher Kit - 2 of each shape (6)	\$ 19.50	<b>\$ 9.75</b>
19-1006HP-6	Kenda Titanium/Precious Black Pre-polisher Small Flame (6)	\$ 19.50	<b>\$ 9.75</b>
19-1008HP-6	Kenda Titanium/Precious Black Pre-polisher Large Flame (6)	\$ 19.50	<b>\$ 9.75</b>
19-1014HP-6	Kenda Titanium/Precious Black Pre-polisher Wheel (6)	\$ 19.50	<b>\$ 9.75</b>
19-1100HP-6	Kenda Titanium/Precious Green Diamond Kit - 2 of each shape (6)	\$ 71.50	<b>\$ 35.75</b>
19-1106HP-6	Kenda Titanium/Precious Green Diamond Small Flame (6)	\$ 71.50	<b>\$ 35.75</b>
19-1108HP-6	Kenda Titanium/Precious Green Diamond Large Flame (6)	\$ 71.50	<b>\$ 35.75</b>
19-1114HP-6	Kenda Titanium/Precious Green Diamond Wheel (6)	\$ 71.50	<b>\$ 35.75</b>

\* Cannot be combined with any other offer. Sale ends December 31, 2005 or while supplies last.



## **ISO Update**

- Swiss NF Metals, Inc. is committed to quality. That is why we are proud to announce that we are upgrading our ISO 13485:1996 to the ISO 13485:2003 standard.
- **IMPORTANT:** Many of Swiss NF Metals products are governed under Health Canada's Medical Device Licence's rules & regulations. In order to adhere to these rules & regulations, Swiss NF Metals will not be able to return and give credit for OPENED packages of product purchased. This rule will be especially enforced for all dental attachments. Thank you for your cooperation and understanding.

## **Important Dates**

**September 15 – 18, 2005:** Canadian Academy of Restorative Dentistry and Prosthodontics, Quebec City, Quebec

**September 16 – 17, 2005:** International Dental Congress, Toronto, Ontario

**September 22 – 24, 2005:** 56<sup>th</sup> Canadian Assoc. of Orthodontics Annual Scientific Session, Quebec City, Quebec

**September 23 – 25, 2005:** Canadian Dental Laboratory Association of BC, Richmond, British Columbia

**October 28 – 29, 2005:** Denttechnica du Quebec, Boucherville, Quebec

***For more information, please call us at:  
(416) 510-2220 or 1-800-387-5031***



19-156 Duncan Mill Road, Toronto, ON, M3B 3N2, Ph: 416-510-2220 or 800-387-5031, Fax: 416-510-2207, www.swissnf.com  
sales - 003 newsletter fall2005